



# Float and Thermostatic Steam Traps

## FLT 17( DN 40 - 50 )

### Description

FLT 17 float and thermostatic (integral air vent) steam traps are designed for all types of low and medium pressure steam heating and process equipment. Connections are female screwed or flanged for horizontal or vertical installation.

### Main Features

Modulating discharge.  
Discharges condensate at steam temperature.  
Unaffected by sudden or wide load and pressure changes.

Excellent air discharge (by thermostatic air vent).

**Options:** Equalizing plug ,venting connection and drain plug ( or blow-off valve on cover).  
Saturated and superheated steam.

**Use :**

**AVAILABLE**

**Models :**

FLT 17-4.5 - FLT 17-10 - FLT 17-14 .

**Sizes :**

1-1/2", 2" - DN40,DN50.

**Connections :**

Female screwed ISO 7/1 Rp (BS21)  
Flanged DIN.Special flanges upon request.

**Installation :**

Standard horizontal installation -  
flow from right to left FLT16 (R-L)

**Upon request:**

-horizontal installation with the flow from left to right FLT17 (L-R)

-vertical installation with the flow from top to bottom FLT17 (V)

See IMI, installation and maintenance instructions.

PMA :Max.allowable pressure 16 bar

TMA: Max.allowable temperature 250 °C

PMO: Max.operating pressure 14 bar

TMO: Max.operating temperature 198 °C

How to order: i.e. FLT17-10 DN 40 DIN.

### Max.differential pressure

FLT 17- 4.5 - 4.5 bar

FLT 17- 10 - 10 bar

FLT 17- 14 - 14 bar

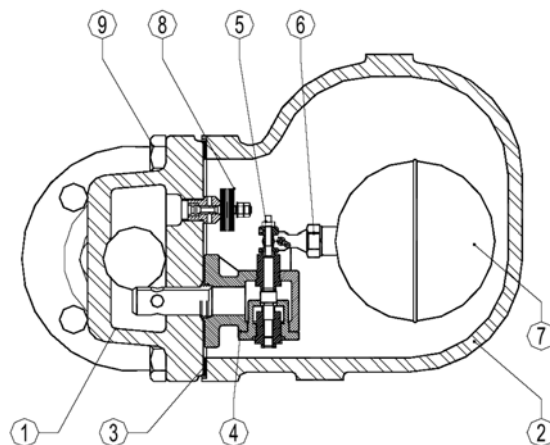

### Materials:

Pos.NR.	Designation	Material
1	Body	GGG 40
2	Cover	GGG 40
3 *	Gasket	Non asbestos
4 *	Seat	AISI 410
5 *	Valve	AISI 410
6 *	Lever	AISI 304
7 *	Float	AISI 304
8 *	Air Vent	Stainless Steel
9	Bolts	Steel 8.8

\* Available Spare Parts

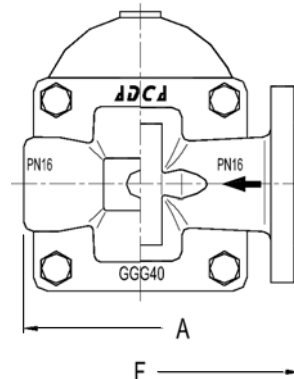
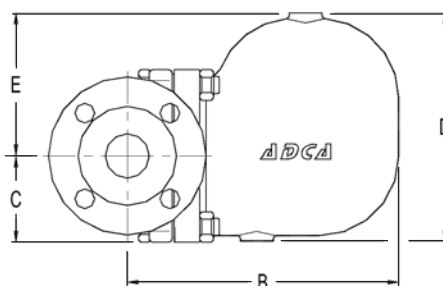

### DIMENSIONS (mm)

Screwed Ends							DIN Flanges		
SIZE DN	A	B	C	D	E	WEIGHT Kg	F	B	WEIGHT Kg
40	210	248	79	208	131	16.9	230	248	20.3
50	210	248	79	208	131	17.5	230	248	22.2

### FLOW RATE CAPACITY IN Kg/h

MODEL	SIZE	DIFFERENTIAL PRESSURE (bar)											
		0.1	0.3	0.5	0.7	1	1.5	2	4.5	7	10	12	14
FLT17-4,5	40-50	1100	1800	2400	2800	3400	3900	4500	7300				
FLT17- 10	40-50	650	1200	1500	1750	2000	2600	3000	4000	5400	6200		
FLT17- 14	40-50	450	750	950	1100	1300	1600	1800	2600	3250	3900	4210	4950

Recommended safety factor : continuous 1.2 - 1.5 ; discontinuous flow 2 - 3 .



## INSTALLATION AND MAINTENANCE INSTRUCTIONS

### FLT17

### FLOAT & THERMOSTATIC STEAM TRAPS

#### GENERAL

1. These instructions must be carefully read before any work involving products supplied by VALSTEAM ADCA ENGINEERING S.A. is undertaken.
2. The installation procedure is a critical stage in a life of a steam trap and care should be taken to avoid damage to the trap or equipment.

#### **Warning !**

- At start up , the presence of small particles in the water (dirt,scale,weld splatters,etc) may cause an unperfect closure of the seat . If this occur, proceed to an accurate cleaning.
- Do not touch the equipment without appropriate protection during working operation because it may conduct heat if the used fluid is at high temperature.
- Before starting maintenance be sure that the equipment is not pressurized or hot .
- The equipments must be used within the working temperature and pressure limits laid down for them, otherwise they may fail ( refer to nameplate and/or IS- Information Sheet).
- Do not remove the nameplate attached to the equipment. Serial number and other useful information is stamped on it.

#### INSTALLATION

1. Before to install remove plastic covers placed on flanges or connection ends. The equipment has an arrow or Inlet/Outlet designations. Be sure that it will be installed on the appropriate direction.
2. Install the steam trap in the point of the system, where the condensate tends to collect. It must be installed with the float lever in horizontal plane, so that it rises and falls vertically. An ADCA strainer should be installed upstream of the trap.

#### **Limiting conditions FLT 17 :**

PMA :Max.allowable pressure	16 bar
TMA: Max.allowable temperature	250 °C
PMO: Max.operating pressure	14 bar
TMO: Max.operating temperature	198 °C

#### **Max.differential pressure :**

FLT 17-4.5 - 4.5 bar
FLT 17 -10 - 10 bar
FLT 17- 14 - 14 bar

#### MAINTENANCE

1. We recommend that the float steam traps are serviced as necessary. Steam traps should be checked periodically (at least yearly), to verify that they are operating correctly and to clean the internal parts and screen (if any).
2. When reassembling make sure that all gasket faces are clean and always use a new gasket. Tighten cover bolts uniformly in a diagonal sequence.
3. For further information refer to the relevant FLT17 brochure or consult our Sales Office.

#### **CE Marking :**

This product have been designed for use on steam and water wich are in Group 2 of the PED-European Pressure Equipment Directive 97/23/EC and it comply with those requirements.  
The product fall within category SEP and must not be CE marked.

#### GROUP 2 GASES CATEGORIES

MODEL	SIZES	Category
FLT 17	ALL	SEP
FLT17HC	DN 25	SEP

**PARTS LIST FOR FLT 17- STEAM TRAPS DN 1/2"- 1", DN15-DN25**

Code	Designation	SizeTrap	Pos.Nr.	Qty.
A.92.1502.015	Valve,seat,float&gasket D.P.4,5bar	DN1/2"-1"	3,4,5,6,7	1Set
A.92.1503.015	Valve,seat,float&gasket D.P.10 bar	DN1/2"-1"	3,4,5,6,7	1Set
A.92.1504.015	Valve,seat,float&gasket D.P.14 bar	DN1/2"-1"	3,4,5,6,7	1Set
A.92.1502.115	Float & gasket	DN1/2"-1"	3,7	1Set
A.92.1502.215	Air vent & gasket	DN1/2"-1"	3,8	1Set

**Recommended tightening torques FLT17 DN 1/2"-1", DN15-DN25**

Pos.Nr.	Size	Nm
4	1/2"-1"	50-55
8	1/2"-1"	50-55
9	1/2"-1"	40-45

Remarks: Tighten cover bolts uniformly.

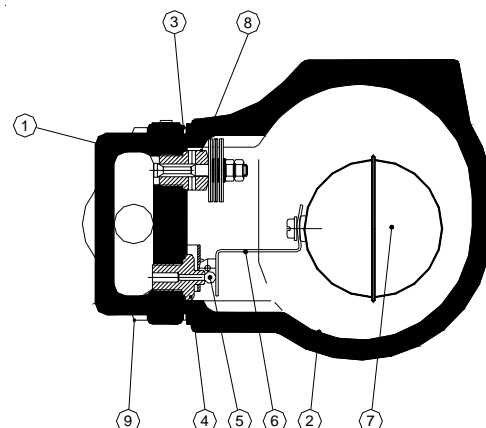

**PARTS LIST FOR FLT 17HC STEAM TRAPS DN 1", DN25**

Code	Designation	SizeTrap	Pos.Nr.	Qty.
A.92.1502.025	Valve,seat,float&gasket D.P.4,5bar	DN1"	3,4,5,6,7	1Set
A.92.1503.025	Valve,seat,float&gasket D.P.10 bar	DN1"	3,4,5,6,7	1Set
A.92.1504.025	Valve,seat,float&gasket D.P.14 bar	DN1"	3,4,5,6,7	1Set
A.92.1502.125	Float & gasket	DN1"	3,7	1Set
A.92.1502.225	Air vent& gasket	DN1"	3,8	1Set

**Recommended tightening torques FLT17HC DN 1", DN25**

Pos.Nr.	Size	Nm
4	1"	50-55
8	1"	50-55
9	1"	40-45

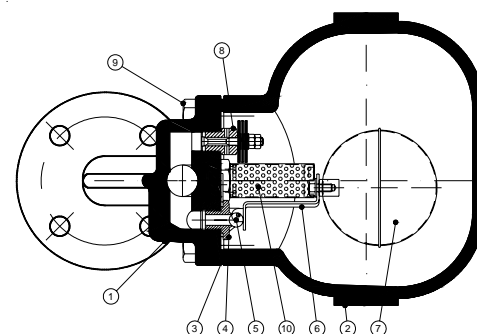
Remarks: Tighten cover bolts uniformly.

**PARTS LIST FOR FLT 17 STEAM TRAPS DN DN40-DN50**

Code	Designation	SizeTrap	Pos.Nr.	Qty.
A.92.1502.040	Valve,seat,float&gasket D.P.4,5bar	DN11/2"-2"	3,4,5,6,7	1Set
A.92.1503.040	Valve,seat,float&gasket D.P.10 bar	DN11/2"-2"	3,4,5,6,7	1Set
A.92.1504.040	Valve,seat,float&gasket D.P.14 bar	DN11/2"-2"	3,4,5,6,7	1Set
A.92.1502.140	Float & gasket	DN11/2"-2"	3,7	1Set
A.92.1502.240	Air vent& gasket	DN11/2"-2"	3,8	1Set

**Recommended tightening torques FLT17 DN40-DN50**

Pos.Nr.	Size	Nm
4	11/2"-2"	10-15 (4xM6)
8	11/2"-2"	50-55
9	11/2"-2"	80-85

Remarks: Tighten cover bolts uniformly.

